

FOR SALE

COMMERCIAL - FACTORY (B2) 2,314SQFT (215SQM) / CALL FOR PRICE!

+65 9328 7000

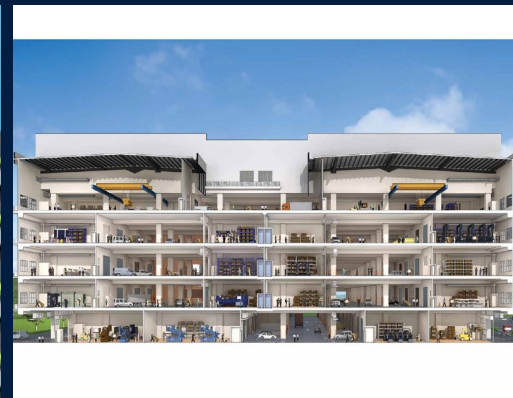

2nd - 4th Storey Plan

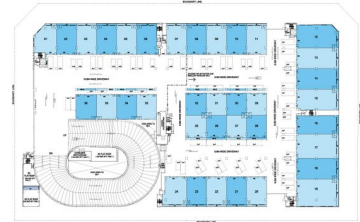

#D-01 2287 sqft #D-07 2214 sqft #D-13 2261 sqft
#D-02 2214 sqft #D-08 2214 sqft #D-14 2261 sqft
#D-03 2214 sqft #D-09 2214 sqft #D-15 2261 sqft
#D-04 2214 sqft #D-10 2214 sqft #D-16 2217 sqft
#D-05 2214 sqft #D-11 2228 sqft #D-17 2266 sqft
#D-06 2266 sqft #D-12 2228 sqft #D-18 2261 sqft
#D-19 4273 sqft #D-20 1910 sqft #D-21 1910 sqft
#D-22 2228 sqft #D-23 1910 sqft #D-24 1910 sqft
#D-25 2228 sqft #D-26 1910 sqft #D-27 1910 sqft
#D-28 2228 sqft #D-29 1910 sqft #D-30 1910 sqft
#D-31 2228 sqft #D-32 1910 sqft #D-33 2266 sqft

COMMERCIAL - FACTORY (B2)

11, TUAS SOUTH LINK 1, BOON LAY, JURONG, TUAS,
SINGAPORE 636901

- LISTING ID: SGLD61062605
- TENURE: LEASEHOLD 30
- TITLE: N/A
- SIZE BUILT-UP: 2,314SQFT (215SQM)
- SIZE LAND: 12.701AC (5.140HA)
- NO. OF FLOORS: 6
- FLOOR/LEVEL: 3 - MIDDLE FLOOR
- PARKING SPACES: N/A
- LAYOUT TYPE: REGULAR
- FACING: N/A
- VIEWING: OTHER
- SELLING PRICE: **CALL FOR PRICE!**
- COMPLETION YEAR: 2017
- CONDITION: ORIGINAL CONDITION
- LISTING DATE: OCT 04, 2019

SHINE@TUAS SOUTH

EXTERIOR FACILITIES

- 24 Hours Security
- Open Car Park
- Covered Car Park
- Dining / Restaurant

VISIT THIS PROPERTY AT: <https://www.evangelinegohutttons.com/property/SGLD61062605>

EVANGELINE GOH - HUTTONS ASIA PTE LTD

3 Bishan Place #05-01 CPF Bishan Building
D20, 579838, Singapore

+65 9328 7000
WhatsApp Me

evangelinegohutttons@gmail.com

<https://www.evangelinegohutttons.com>



Scan QR Code

Huttons® Call for Viewing
The Agency of Choice +65-93287000